

PIANISTA

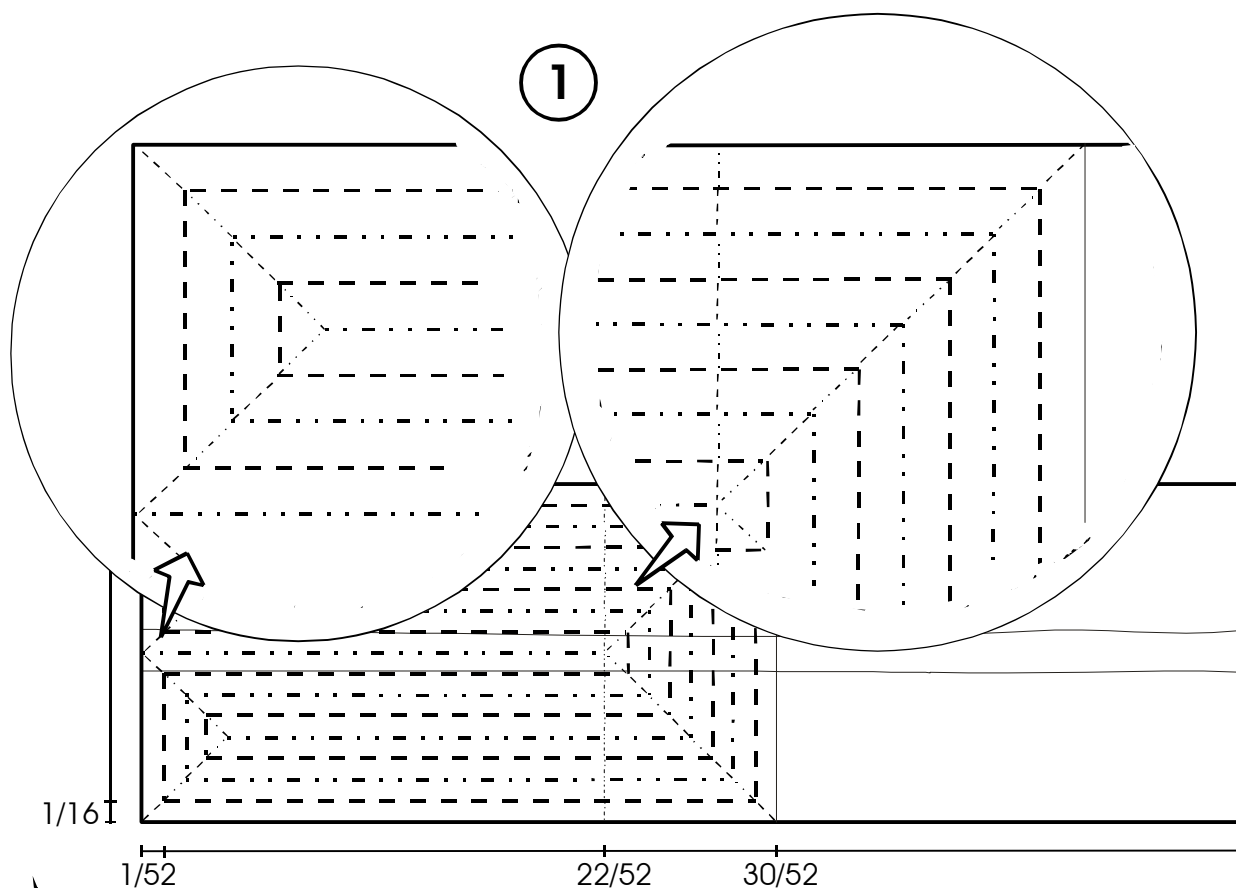

Utilizzare un rettangolo di formato 1x3,25
e squadrare tutto il foglio in 16x52.
Preparare in precedenza il foglio con la
striscia di "scotch" sulla mediana lunga.
Parte colorata sotto.

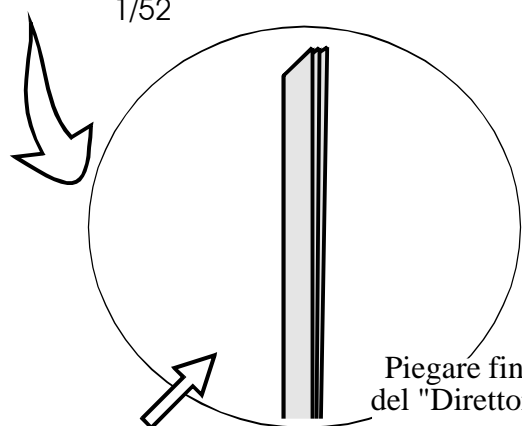

Piegare fino al punto 15
del "Direttore d'orchestra"

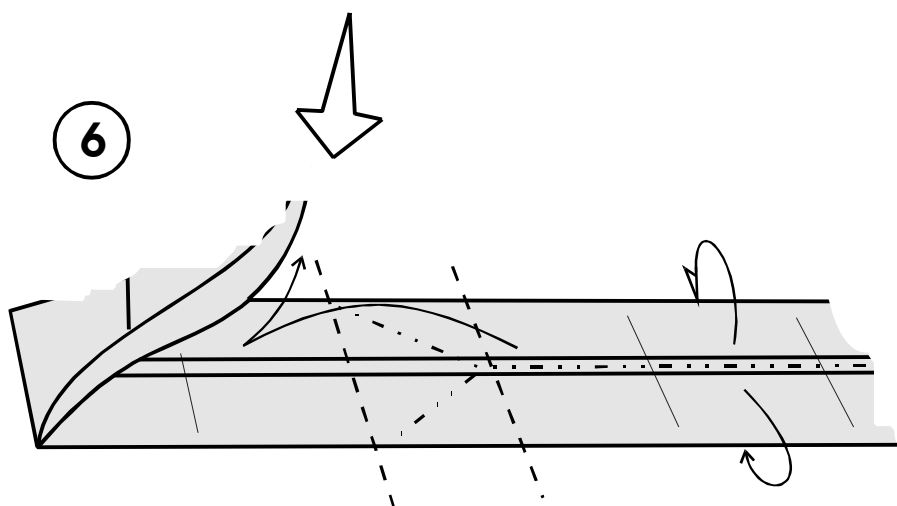
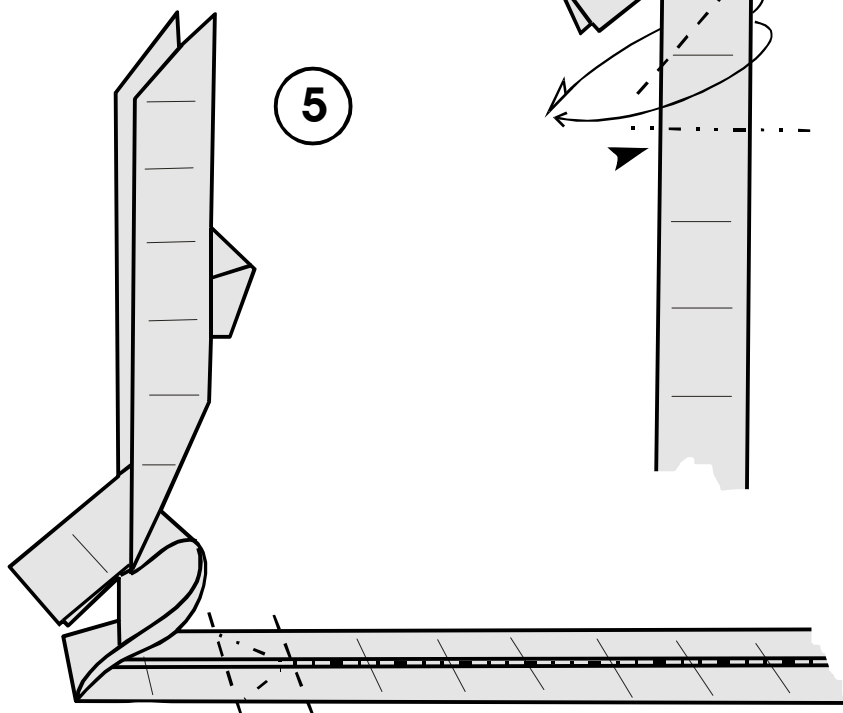
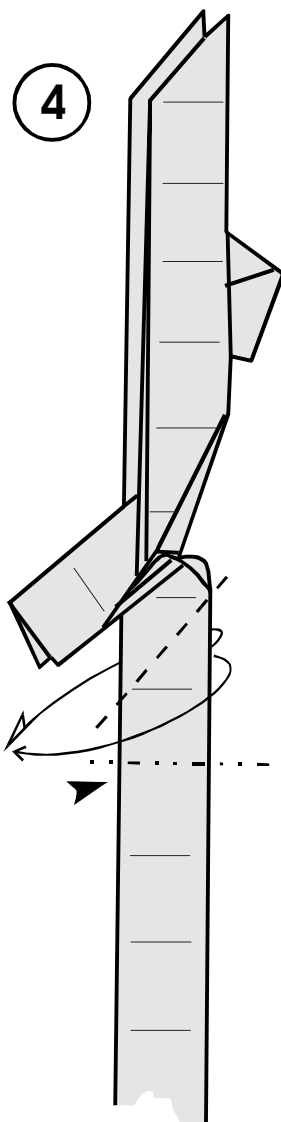
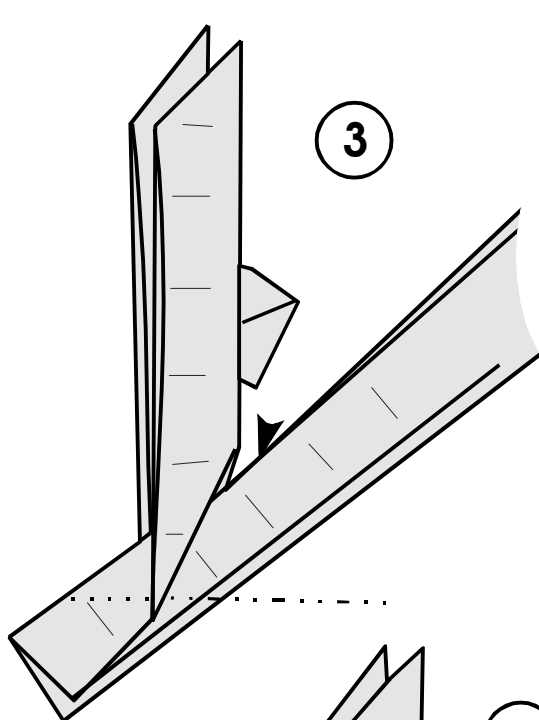

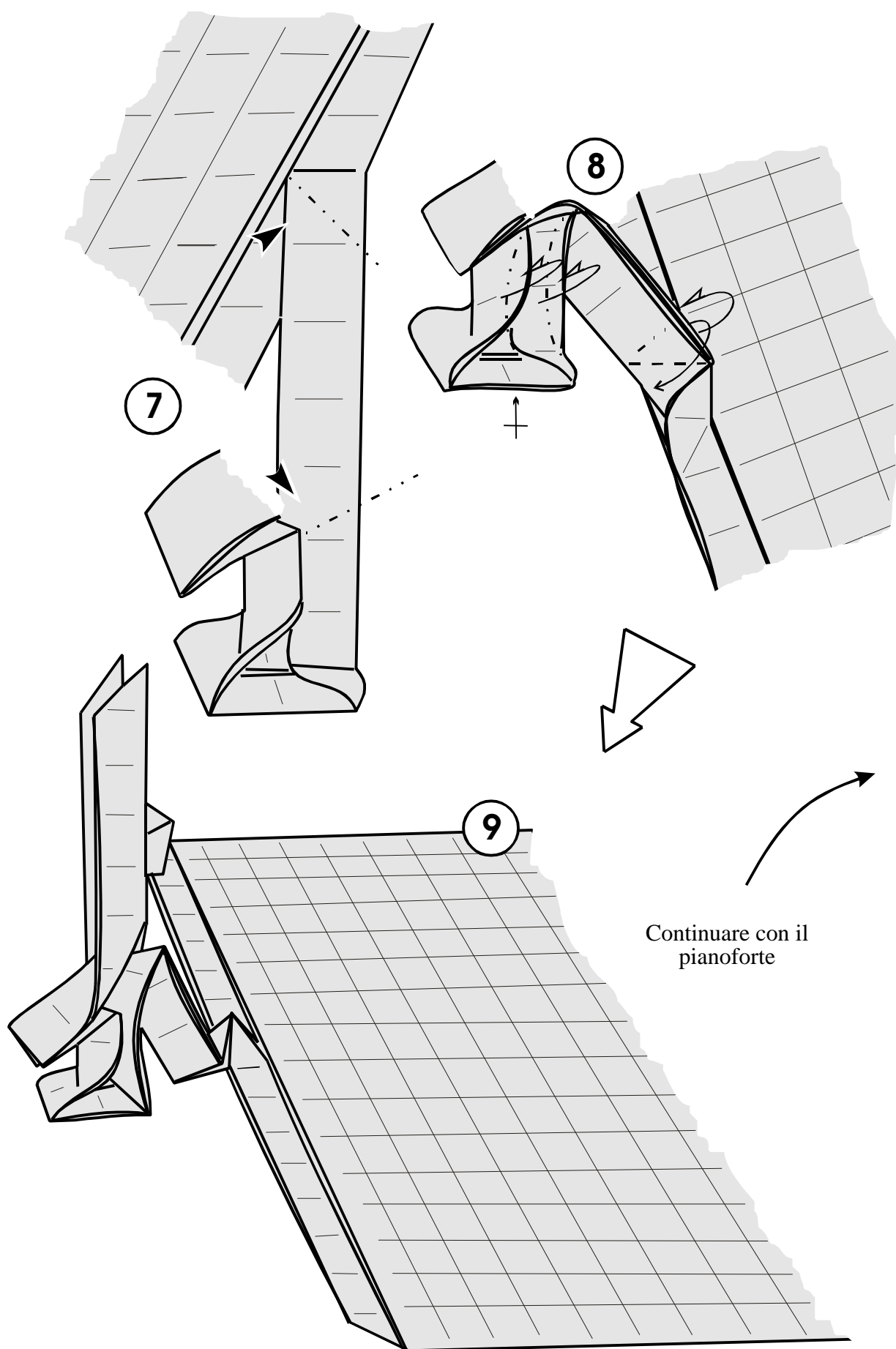

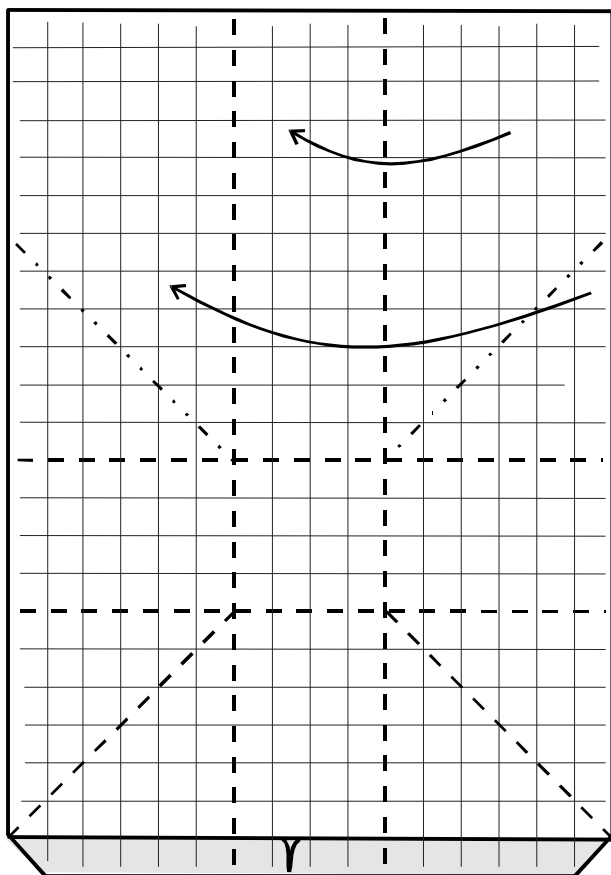

10

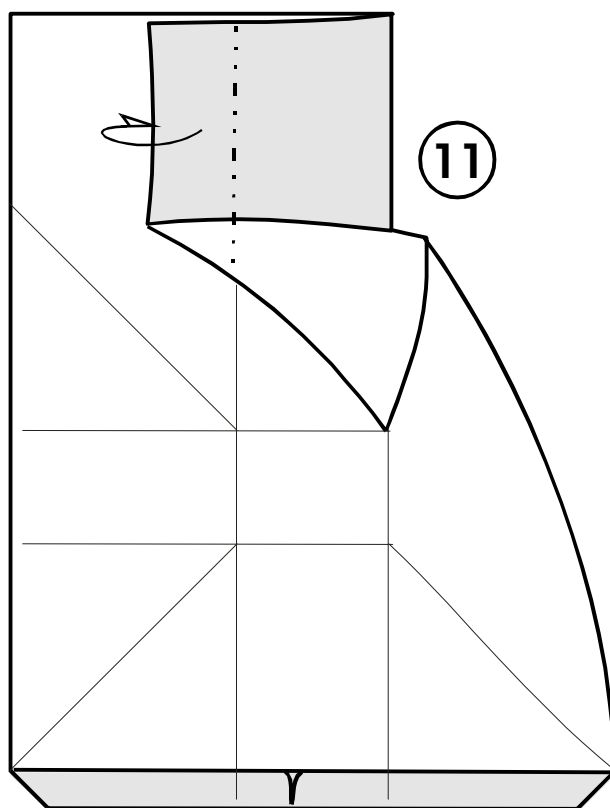

11

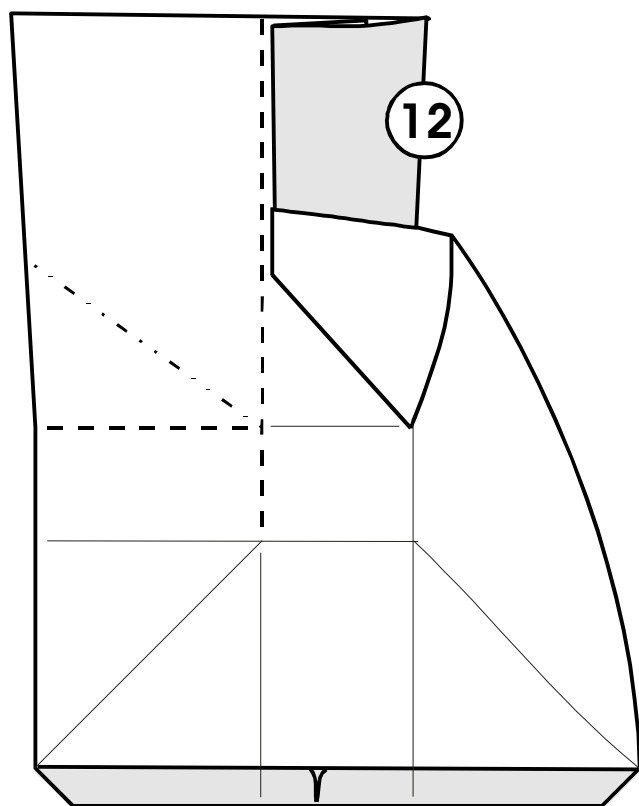

12

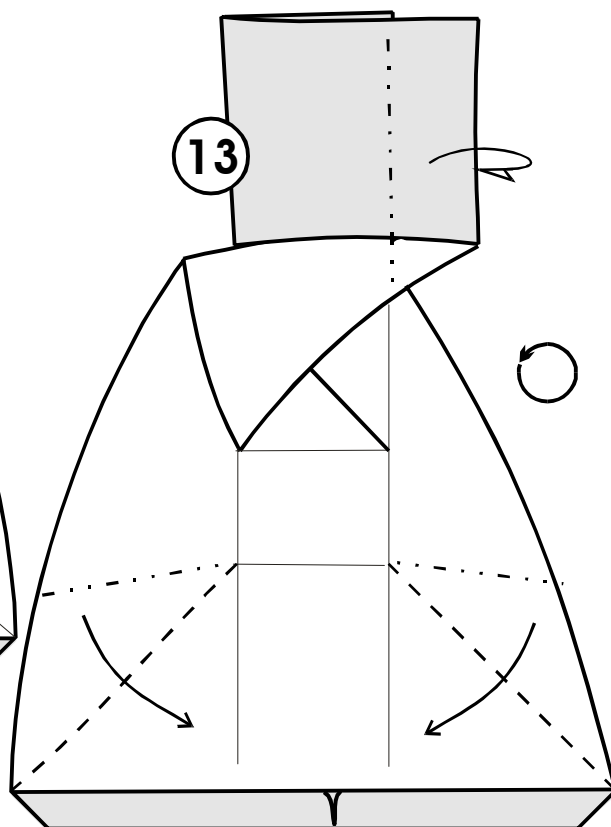

13

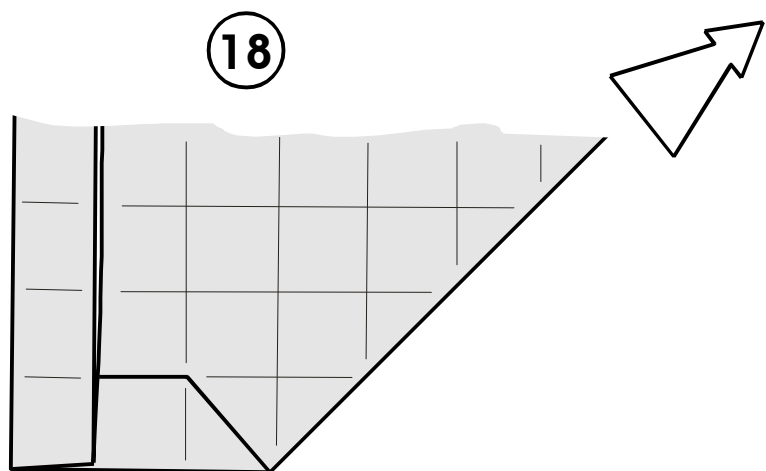
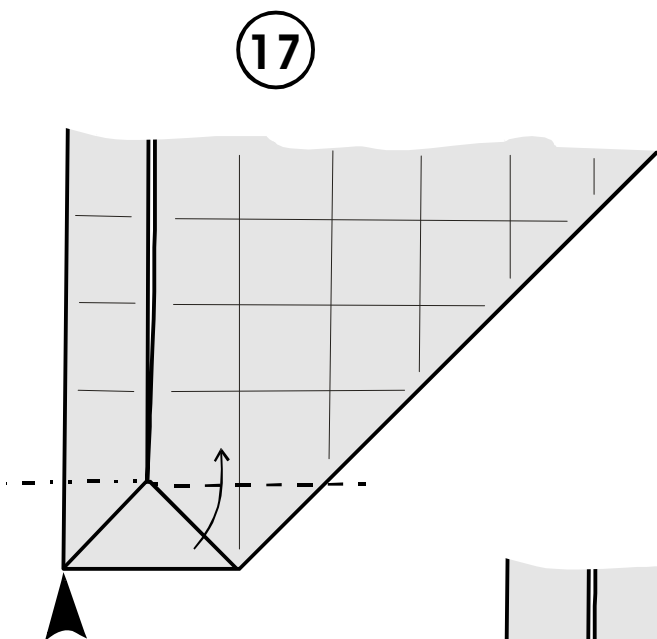
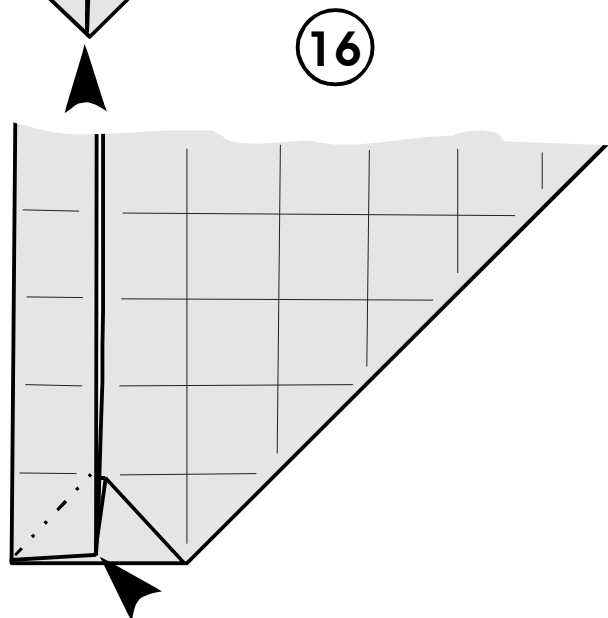
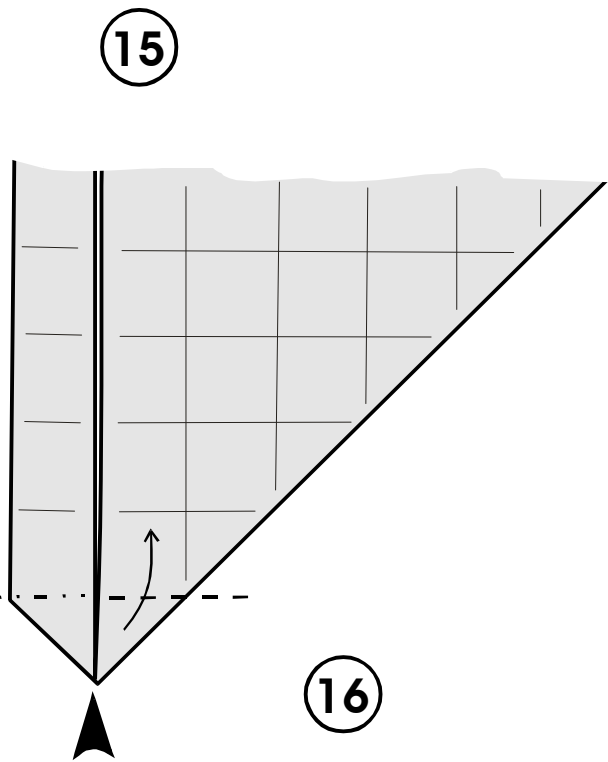
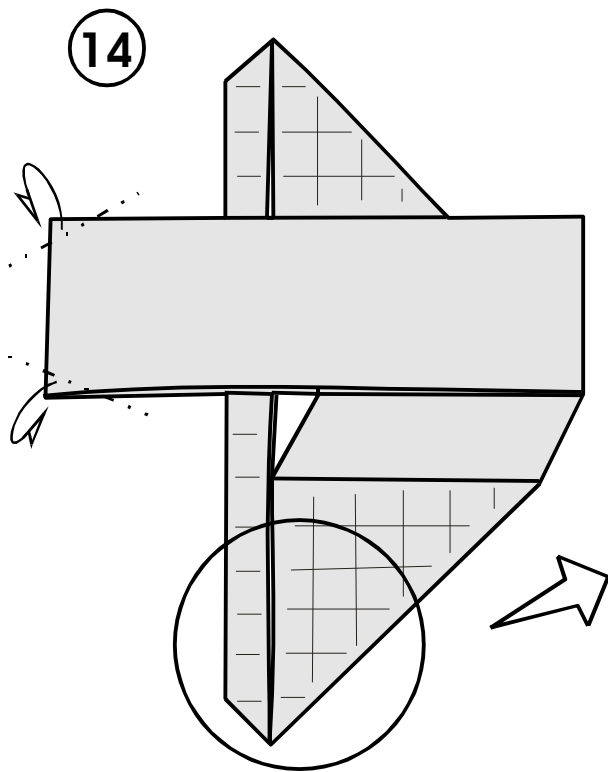

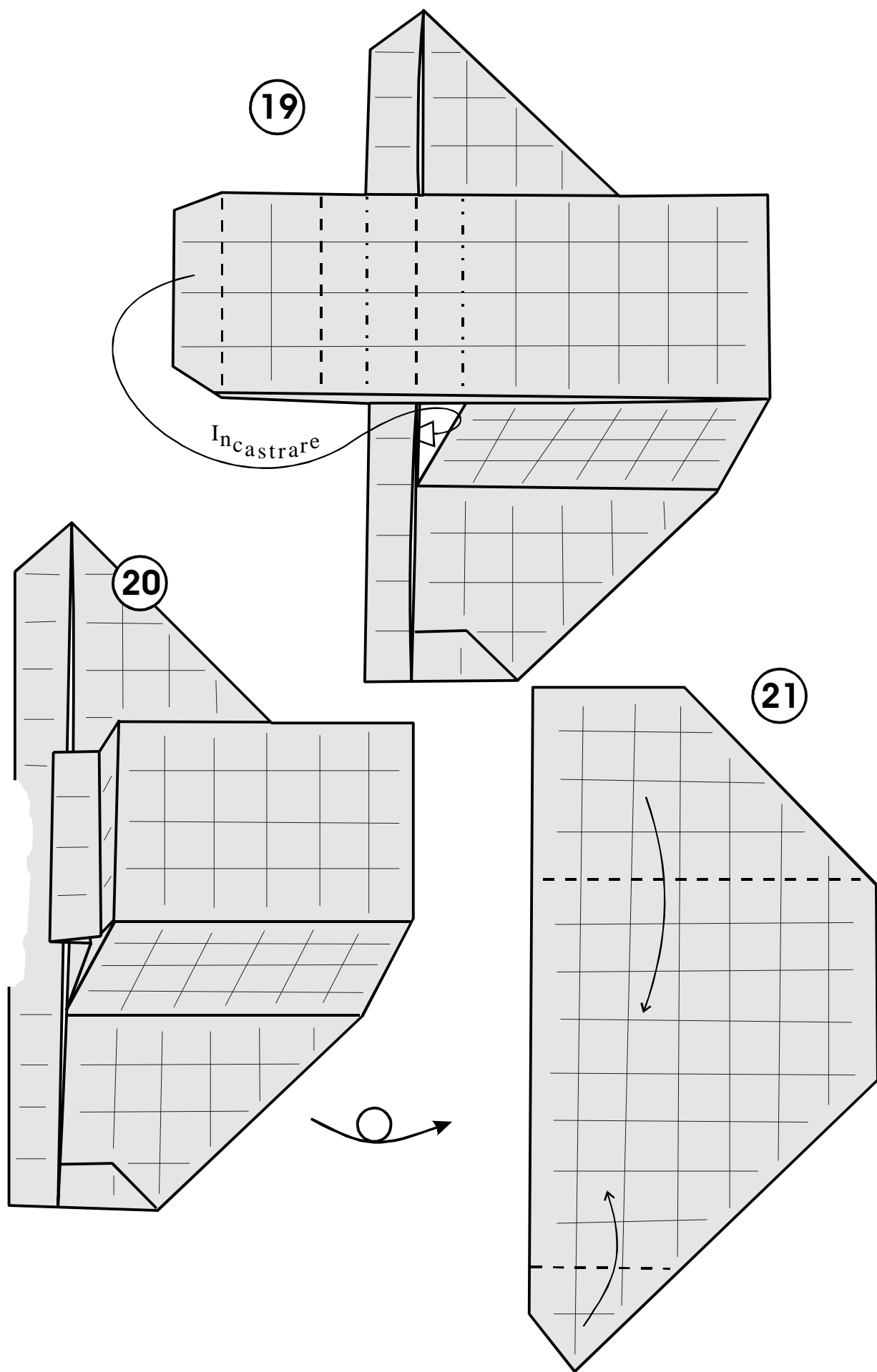

22

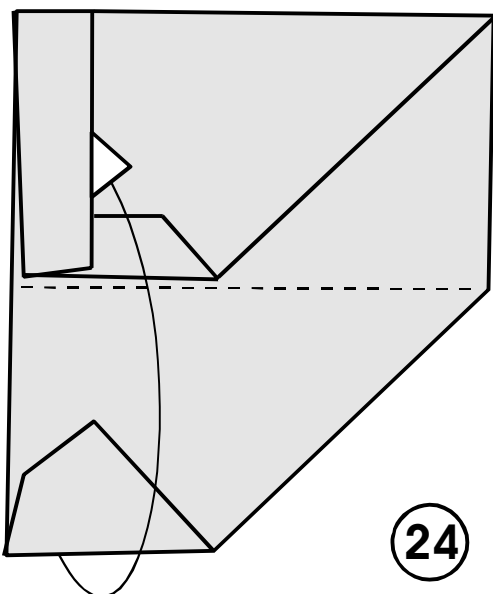

Incastrare

23

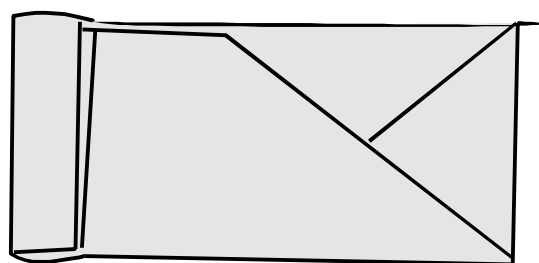

24

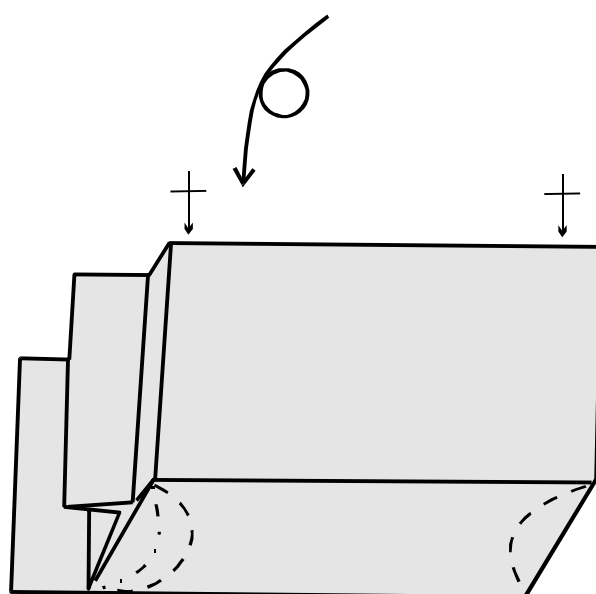

Pizzicare

Ora, per dare forma alla coda del frac e alle braccia, vedere il punto 24 del "Direttore d'orchestra". Modellare il corpo come indicato al punto 32; infine, piegare le braccia in modo da dare l'impressione che il pianista stia suonando.

25

